

What is Included



1. Remove the Ratchet, Blue container with the Vertical Spindle and Hex Wrench from the box.
2. Open the blue box containing the Vertical Spindle (be careful as this is spring-loaded)
3. Remove black rubber cover on opposite side from blue knurled end.

4. Once exposed, you'll see a spring-loaded rod with a brass washer. This end will thread into the Steady Eddy Ratchet. (The opposite end will have the thumb button)

Above the forward/reverse switch, the round opening is where you will thread in the Vertical Spindle.

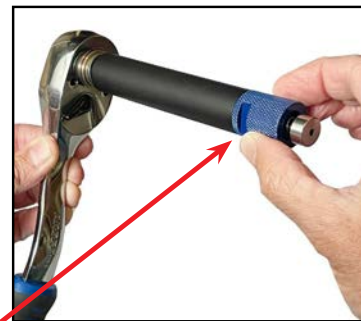
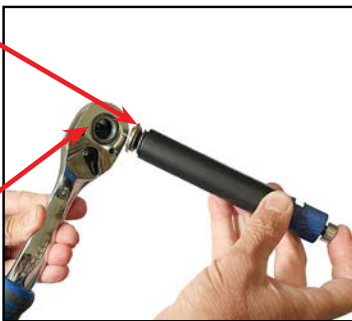

5. Pushing the Spindle inward, begin threading (clockwise) with the blue knurled end.

6. Hand tighten knurl until it stops.

7. Lie the ratchet on a flat surface. With the provided Hex Wrench, push the inward into the Ratchet, and tighten the thumb button (clockwise) with the Hex Wrench.

8. As the button's threaded end engages inside the ratchet, continue threading with hex wrench, until it's hand-tight.

***Be sure that the brass washer stays lined up with the spindle.**

9. Test to assure the Thumb Button is controlling the steel ball and the drive gear is working. (This will lock in the 1/2" socket)

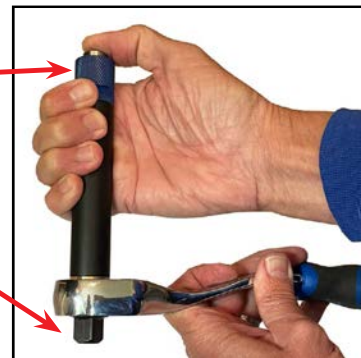
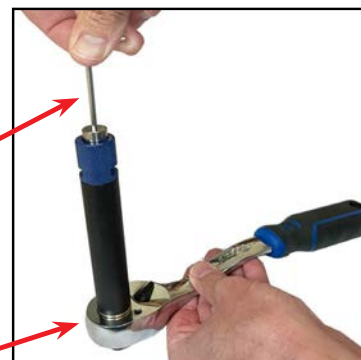

Your Steady Eddy is now assembled. You can now attach Sockets to the Ratchet and ensure that you no longer cross thread and have much more stability in installing or removing threaded fittings.